

# CONTI iQ lavatory faucet A20

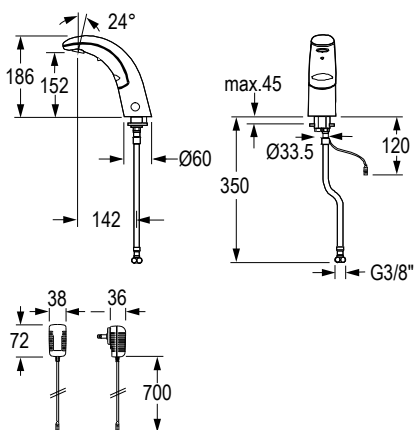

iQ lavatory faucet A20, with IR sensor, without temperature-mixing (for cold or premixed water), chromed

Touchless, electronically controlled lavatory faucet:

- Modular single-piece design without separate installation box, sturdy metal housing, chromed
- Dual infrared sensors (with automatic setting feature), microprocessor
- Reliable solenoid valve ROBUST (minimal level of water pressure surge) and economic aerator
- Cold water supply connection with flexible hose and built-in filter
- Temporary-off (cleaning) and continuous water flow time (filling of basin) activated by Click-plus
- Continuous water flow time and hygienic flush time adjustable with function key
- Follow-up time and sensor sensitivity adjustable with function key
- 12, 24 or 48-hour hygienic flush activatable with function key
- Installation similar to conventional single-lever faucet
- Compatible with CNX and Service APP: Control of stored operational data, settings and control functions

Click:

Recessed function key - without additional functions

Click-plus:

Protruding function key Click-plus (continuous-on, temporary-off)

Battery:

6 V Lithium 2 CR5 - commercial; life time up to 4 years

Mains supply:

Plug-in transformer 110-240 V 50-60 Hz / 6 V

VARIOconnect:

For single and multiple power supply and data connection (Connection CNX and Service APP - see accessories)

Operating pressure: 0,3-10 bar

Flow rate (approx.): 6 l/min / 1,6 gpm (3 bar)

Water temperature (max.): 80 °C

Aerator: Economic aerator, CASCADE (self-cleaning)

Flexible hose: 350 mm

Angle valve connection: G 3/8

Built-in filter: 0,5 mm mesh size

Sensor sensitivity: Automatic self-adapting sensor technology

Follow-up time: 1 s pre-set (adjustable with function key 0-10 s)

Continuous water flow and hygienic flush time: 2 min pre-set (adjustable with function key 0,5-20 min)

Temporary-off: 2 min (fixed)





Engineering standards: DIN EN 200; Noise class I; P-IX 9576 / IA; Cc

## Note:

When integrated into the CNX Water Management System, the CNX Converter 6 V must be ordered separately.

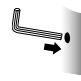
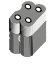
When using the Service APP, the BLE Converter must be ordered separately.

Only possible with mains and VARIOconnect versions.

Version		 Function key Click-plus	 Function key Click
Power supply	Drain assembly	Article number	Article number
 Battery	Without	<b>100.140.11</b>	<b>100.040.11</b>
 Mains operation 	Without	<b>100.150.11</b>	<b>100.050.11</b>
 VARIOconnect 	Without	<b>100.156.11</b>	<b>100.056.11</b>