



# ASSEMBLY INSTRUCTIONS

**HLS5 / HLS5H**

# 1 Drilling



Front view

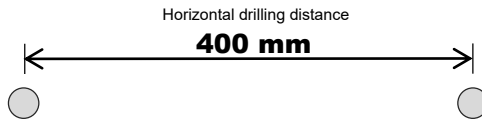

# 2 Dowel

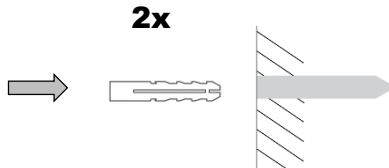

### 3 Installation of wall bearings

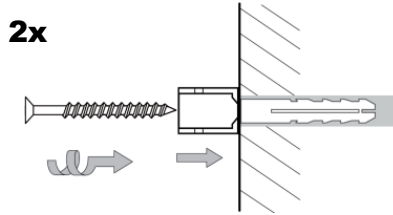

### 4 Attach & fix the hook strip

**4a**

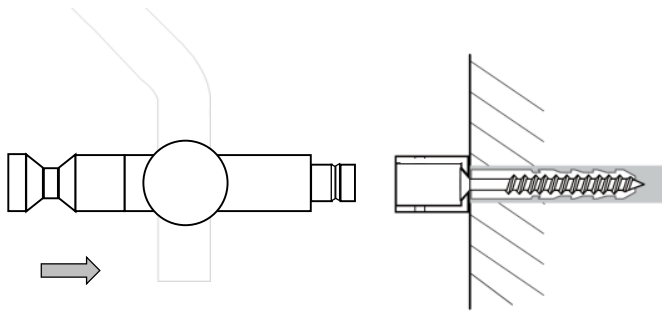

**4b**

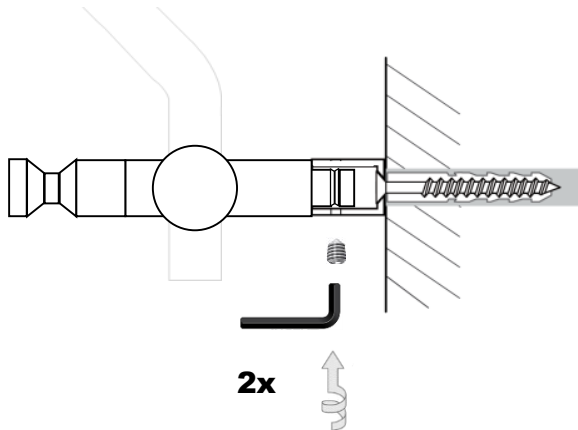

## CLEANING INSTRUCTIONS STAINLESS STEEL

### DRY CLEANING

Normal dry cleaning is done with a soft, lint-free cloth. The frictional force should be kept as low as possible, otherwise the surface can change.

### WET CLEANING

Soft, lint-free cloths are also suitable for wet cleaning. Dampen the cloth with water, wring it out and clean with a damp cloth.

### DANGER:

1. In the case of heavy soiling, only use CHLORINE-FREE, MILD cleaning agents (it is essential to follow the manufacturer's recommendations and instructions).
2. Never use abrasive cleaners and sponges.
3. The friction force should be kept as low as possible, otherwise the surface may change.

### NOT SUITABLE FOR CLEANING

1. Detergents containing hydrochloric, chloric or hydrofluoric acid
2. Nonwovens containing abrasives
3. Materials made of unalloyed steel (e.g. steel brushes, steel wool, etc.)
4. Chrome, silver and brass polish
5. Furniture polishes

### AS A CLEANING AGENT, WE RECOMMEND THE PHOS STAINLESS STEEL CLEANER V2AR:

1. Remove coarse dirt.
2. Clean the surface with a slightly damp cloth.
3. Apply the PHOS stainless steel cleaner thinly.
4. Then polish the surface until it is dry. Please use only soft and lint-free towels and keep the frictional force as low as possible.

