

CONTI  maxx lavatory faucet M20

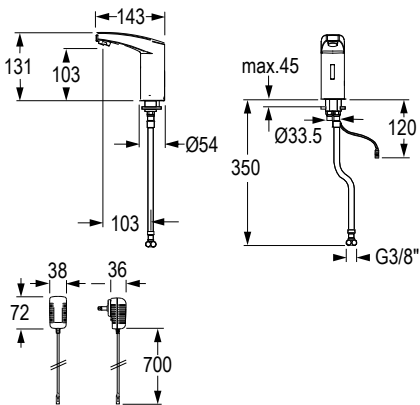

maxx lavatory faucet M20, with IR sensor, without temperature-mixing (for cold or premixed water), chromed





Touchless, electronically controlled lavatory faucet:

- Modular single-piece design without separate installation box, sturdy metal housing, chromed
- Integrated battery (maintenance via service cover)
- Infrared sensors with automatic setting feature, microprocessor
- Reliable solenoid valve ROBUST (minimal level of water pressure surge) and economic aerator
- Cold water supply connection with flexible hose and built-in filter
- Temporary-off (cleaning) and continuous water flow time (filling of basin) adjustable with Touch
- Continuous-on and hygienic flush time adjustable with Touch
- Follow-up time, sensor-sensitivity adjustable with Touch
- 12, 24 or 48-hour hygienic flush adjustable with Touch
- Installation similar to conventional single-lever faucet
- Compatible with CNX and Service APP: Control of stored operational data, settings and control functions

Battery: 6 V Lithium CRP2 - commercial; life time up to 4 years
 Mains supply: Plug-in transformer 110-240 V 50-60 Hz / 6 V
 VARIOconnect: For single and multiple power supply and data connection (Connection CNX and Service APP - see accessories)

Operating pressure: 0,3-10 bar;
 Flow rate (approx.): 6 l/min / 1,6 gpm (3 bar)
 Water temperature (max.): 80 °C
 Aerator: Economic aerator, CASCADE (self-cleaning)
 Flexible hose: 350 mm
 Angle valve connection: G 3/8
 Built-in filter: 0,5 mm mesh size
 Sensor sensitivity: Automatic self-adapting sensor technology
 Follow-up time: 1 s pre-set (adjustable with Touch 0-10 s)
 Continuous water flow and hygienic flush time: 2 min pre-set (adjustable with Touch 0,5-20 min)
 Temporary-off: 2 min (fixed);
 Engineering standards: DIN EN 200; CEE

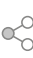
Note: When integrated into the CNX Water Management System, the CNX Converter 6 V must be ordered separately.
 When using the Service APP, the BLE Converter must be ordered separately.
 Only possible with mains and VARIOconnect versions.

| Power supply | Drain assembly | Colour | Article number |
|---|----------------|--------|-------------------|
|  Battery | Without | Chrome | 131.040.11 |
|  Mains operation  | Without | Chrome | 131.050.11 |
|  VARIOconnect  | Without | Chrome | 131.056.11 |